

PLEASE START HERE:

Thank you for purchasing the Trade Fixtures Gravity Feed Bin.

If you use your own shelving, each shelf span must support, without sagging, 25 lbs (11kg) for each 3 gallon bin, 45 lbs (20kg) for each 5 gallon bin, and 150 lbs (68kg) for the 12 gallon bin (90# (40kg) rated capacity). A 48" by 12" deep metal grocery gondola shelf is typically rated to hold 500 lbs, but check with the manufacturer. If you wall-mount a shelf, heavy duty brackets every 16" on center screwed to the shelf is required. If you design your own custom cabinets, contact our professional designer if you have any questions.

ALWAYS INSPECT GRAVITY BINS DAILY TO ENSURE THE BINS ARE SECURE ON THE SHELF.

Before you begin...we recommend

Remove your food product, and gravity bins from the shelf. Unscrew, and inspect your Trade Fixtures Gravity Bin retaining button and bin base. If cracked, or you see any noticable damage, replace immediately. Otherwise, set aside for reinstallation.



1.Shelf Preparation

Remove food, then bins, then retaining button from shelf. Inspect retaining buttons, and bin base for possible damage. Replace immediately upon discovery. The Gravity Bin secondary locking device can be purchased in a one bin, or a multiple bin application.



2.Secondary Locking Device

Place the secondary locking device on your shelf, and reinstall the retainer buttons as illustrated in step 4.

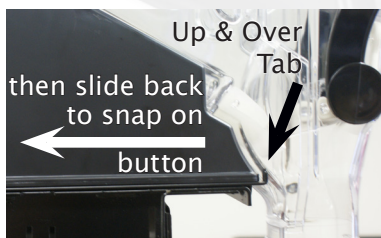
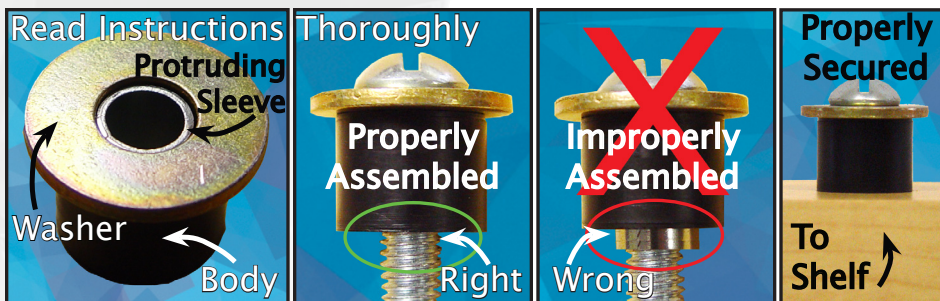

3.Proper Install

Slide bin back to engage retainer button and up and over tabs.

4.Install Retainer Button Body

Tools needed: Flat head Screwdriver, 1/2" wrench/socket, or pliers.

Find the included hardware packet containing: bolt, washer, plastic body, metal sleeve, and a 5/16" nut. This nut is used to secure the bolt to shelves that do not employ a threaded insert. If not already done, insert the metal sleeve into either side of the plastic body, noting the sleeve will protrude out one side. **POSITION THE PROTRUDING SLEEVE THROUGH THE WASHER. INSERT THE BOLT AS SHOWN AND TIGHTEN ONTO THE SHELF. PLEASE NOTE: FAILURE TO INSTALL, OR KEEP THE AREA AROUND THE RETAINER BUTTON FREE OF DEBRIS COULD CAUSE THE BIN TO FALL OFF THE SHELF DURING NORMAL USE CAUSING INJURY TO YOUR CUSTOMER. ALL PARTS ARE NEEDED FOR A PROPER INSTALLATION!!!! YOU SHOULD FEEL AND HEAR A SNAP WHEN BASE STAND SNAPS ONTO THE RETAINER BUTTON PROPERLY.**



CORRECT INSTALLATION

The Gravity Bin is aligned and installed correctly in this photo. The front edge of the bin base should come to rest behind the left and right tab on the secondary locking device, not on top of it, in front of it, or covering it as shown in the following illustrations.

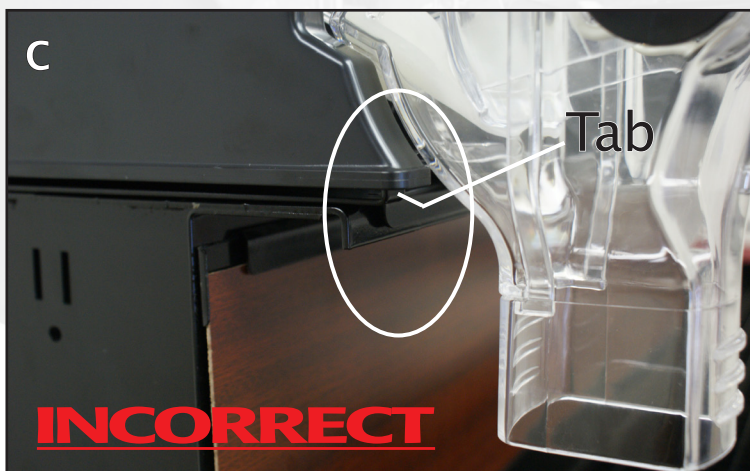
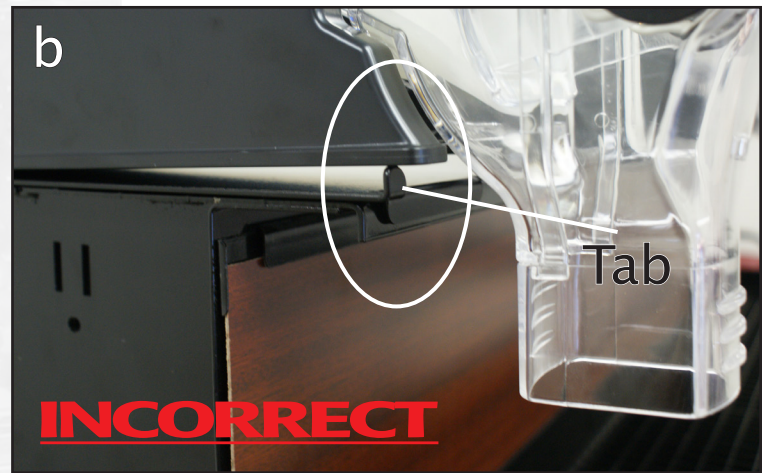

INCORRECT INSTALLATION

The Gravity Bin is misaligned and not installed correctly in these photos.

- a) The front edge of the bin base is beyond the tab
 - b) The front edge of the bin base is resting on the tab
 - c) The front edge of the bin base is covering the tab
- all indicating misalignment and thus incorrect installation.

Please realign bin to match CORRECT INSTALLATION photo above.

FAILURE TO INSTALL THE RETAINING BUTTON, AND SECONDARY LOCKING DEVICE TO THE SHELF COULD RESULT IN BODILY HARM, OR INJURY.