

## PLEASE START HERE:

Thank you for purchasing the Trade Fixtures Gravity Feed Bin.

If you use your own shelving, each shelf span must support, without sagging, 25 lbs (11kg) for each 3 gallon bin, 45 lbs (20kg) for each 5 gallon bin, and 150 lbs (68kg) for the 12 gallon bin (90# (40kg) rated capacity). A 48" by 12" deep metal grocery gondola shelf is typically rated to hold 500 lbs, but check with the manufacturer. If you wall mount a shelf, heavy duty brackets "every 16" on center screwed to the shelf is required". If you are working with a unit for which a retainer button has not already been affixed to a shelf, please see step 1, Retainer Button Installation below. An instruction video can also be found at <http://www.tradefixtures.com>. Steps 1 through 5 below need to be completed each and every time a gravity bin is removed, refilled, and replaced.

## INSPECT GRAVITY BINS DAILY TO ENSURE THE BINS ARE SECURELY AFFIXED TO SHELF.

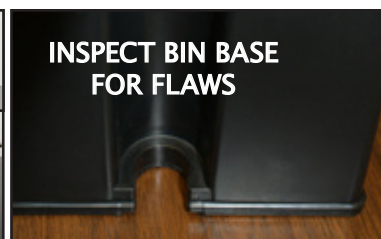
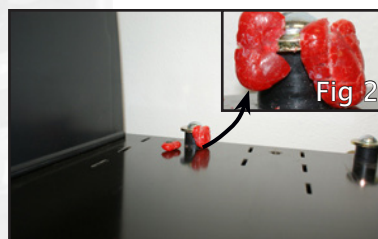
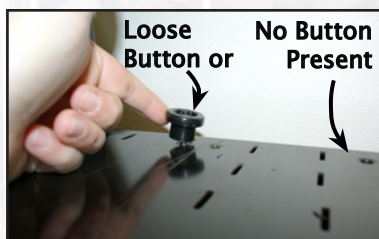
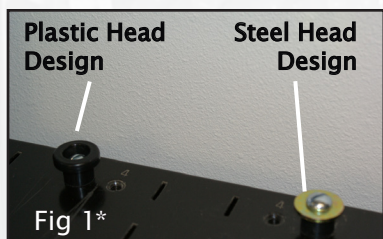

### 1. Identify Retainer Button

Identify the retainer button\* design you have as shown in Fig 1 and check to make sure that it is free of defect and properly secured against the shelf per instructions below. If your shelf does not have a retainer button installed or it is loosely installed, please proceed to and follow these Retainer Button Installation instructions.

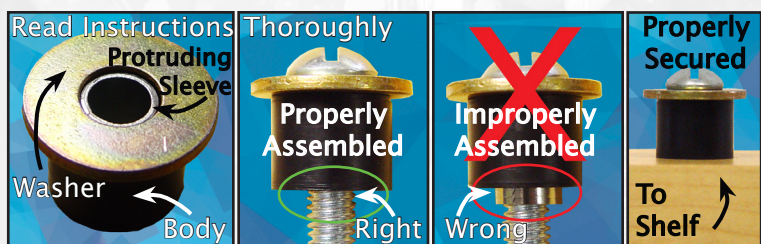

### Retainer Button Installation

**Tools needed: Flat head Screwdriver, 1/2" wrench/socket, or pliers.**

Find the included hardware packet containing: bolt, washer, plastic body, metal sleeve, and a 5/16" nut. This nut is used to secure the bolt to shelves that do not employ a threaded insert. Insert the metal sleeve into either side of the plastic body, noting the sleeve will protrude out one side. Position the protruding sleeve through the washer. Insert the bolt as shown and tighten onto the shelf. **PLEASE NOTE: FAILURE TO INSTALL COULD CAUSE THE BIN TO FALL OFF THE SHELF DURING NORMAL USE AND MAY RESULT IN INJURY.**

**All parts are needed for a proper installation. If you need assistance or additional parts, please contact Trade Fixtures.**



### 1a. Retainer Button Design

\*-The photo in Fig. 1 displays both a plastic head and a steel head retainer button. Both retainer buttons perform the same function. Our engineering team simply created the new steel head retainer button to reduce potential wear and tear and increase the life cycle of your product. If you notice wear and tear on a retainer button that prevents the secure installation of the gravity bin, remove the bin from service immediately, and contact Trade Fixtures to obtain a steel-head retainer button, part #06205A.

### 2. Clear Debris, Check Bin Base and

#### Ensure Proper Installation

Always check your shelf and the area around the retainer button to verify it is clear of food debris, or other items. Fig. 2 shows how food buildup can prevent a secure installation. Ensure the bin base is free of flaws before attaching to shelf. If there is any wear and tear on bin base that may prevent the secure installation of the gravity bin, remove the bin from service immediately, and contact Trade Fixtures to obtain the appropriate replacement part.

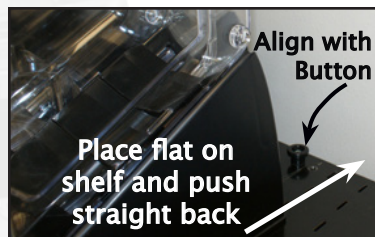

### 4. Ensure Proper Alignment

Align the center of the bin with the retainer button and slowly slide back towards the button. Fig. 3 shows a bin that is improperly being slid into place. Keep the bin base flat on the shelf. This ensures the bin base can snap into union with the retainer button.

**CAUTION: Failure to secure the bin properly to the retainer button using these instructions may cause the bin to be dislodged when its handle is pulled and could cause injury.**

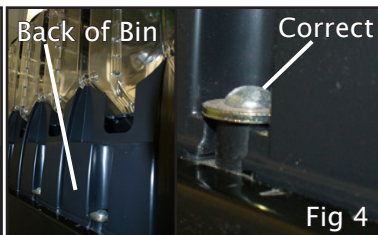

### 5. Push and Snap

Lock bin in place by pushing it straight back, snapping onto the retainer button.

### 6. Safe and Secure

In the previous step, you should feel the bin "SNAP" into place. Fig. 4 shows how the bin base is correctly secured.